

SSC-SET Hex Socket Head Cap Captive Screw/Captive Washer Sets

SUS Stainless steel

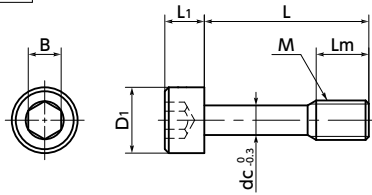

SSC Screw



SWAS-SC Washer

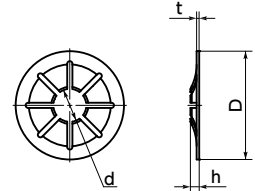

Material/Finish



SSC-SET		
Hex Socket Head Cap	Main Body	SUSXM7 (Equivalent to SUS304)
Captive Screw	Strength Class	A2 - 70
Captive Washer		SUS304*1

*1: **SWAS-5-SC**, **SWAS-6-SC**, and **SWAS-8-SC** are SUS302.

Usage Example

When a screw mounted on a cover is removed from the frame, thanks to the redundant fall protection of the captive screw and captive washer, the screw does not fall.

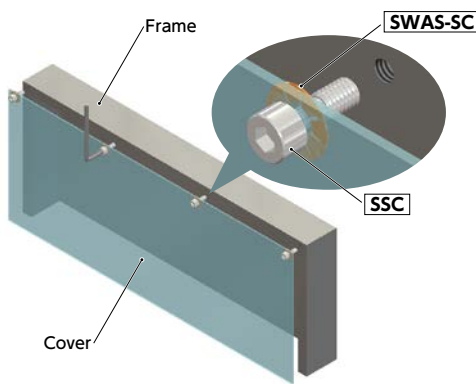

- Set of Hex Socket Head Cap Captive Screw **SSC** and Captive Washer **SWAS-SC**.
- Even when the screw is removed from the frame, **SSC** does not fall out of the cover because the washer hook catches on the screw thread. Even if **SWAS-SC** is damaged, the **SSC** thread part will catch, for double prevention of screw fall-off and loss.

- For CE Marking compatibility.

Application

Screw fall/loss prevention / Fixing of protection covers and covers for inspection / Compliance with CE marking
Machine tools / Food machinery / Electrical and electronic equipment / Infrastructure facilities / Redundant safety measures / Redundant fall prevention

⚠ Precautions for Use

- Screw hole inner diameter on the cover side shall be at least the dc dimension.
- The cover thickness should be 0.8 mm or above.
- Once **SWAS-SC** is mounted on a screw, it cannot be easily removed.
- To remove, either **SWAS-SC** or screw must be cut. Take care when mounting.
- When the screw is loosened with **SWAS-SC** pressed to the cover, **SWAS-SC** may come off.

Installation Example

- ① Make a screw hole in the cover, and then pass the **SSC** thread part through it.
- ② Press-fit **SWAS-SC** into the thread part from the screw tip side. Ensure that the **SWAS-SC** hooks face the frame side. When mounting, use the dedicated tool **SKSC** (sold separately). For the frame side female thread chamfering, refer to **Table 1**.

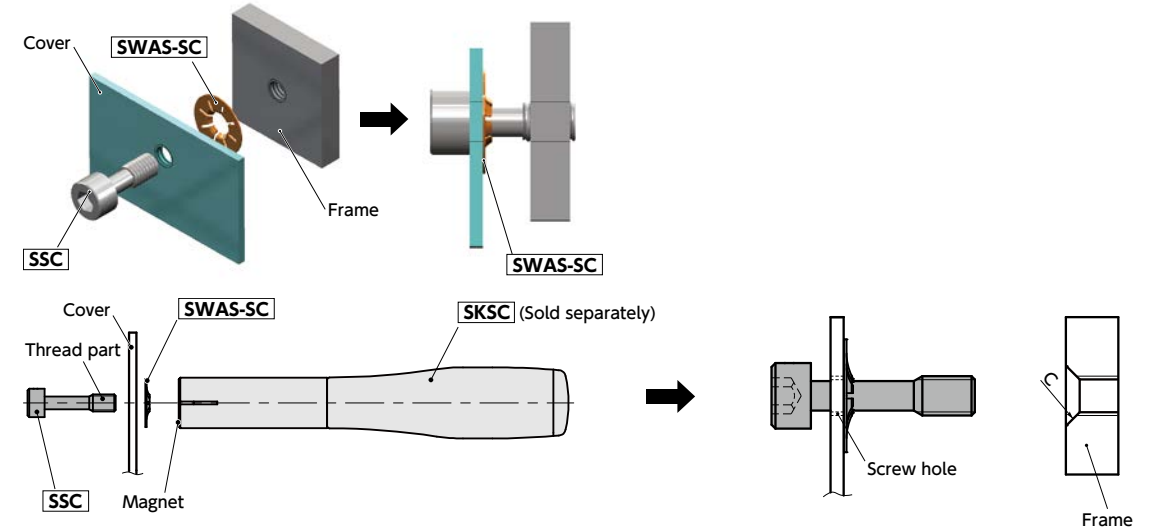

Table 1

Part Number	Applicable Washer	C	Unit : mm
SSC-M3-SET	SWAS-3-SC	1.5 - 2	
SSC-M4-SET	SWAS-4-SC	1.5 - 2	
SSC-M5-SET	SWAS-5-SC	1.5 - 2	
SSC-M6-SET	SWAS-6-SC	1.5 - 2	
SSC-M8-SET	SWAS-8-SC	1.5 - 2	

Part Number	M (Coarse)	Nominal of Thread	Pitch	L																Lm	D1	L1	B	dc	D	d	t	h	Mass (g)	Qty per Pack			
				8	10	12	16	20	25	30	35	40	10	13	8	6	6.3	21.6	6.8												0.4	1.9	13
SSC-M3-SET	M3	0.5	0.5	8	10	12	16														4	5.5	3	2.5	2.2	8	2.6	0.3	0.9	1	-	1.3	10
SSC-M4-SET	M4	0.7	0.7		10	12	16	20													5	7	4	3	3	10	3.4	0.3	0.9	1.9	-	2.8	10
SSC-M5-SET	M5	0.8	0.8			12	16	20	25												6	8.5	5	4	3.9	12.7	3.9	0.3	1.1	3.3	-	5.1	10
SSC-M6-SET	M6	1	1			12	16	20	25	30											8	10	6	5	4.5	15.7	4.7	0.4	1.4	5.6	-	8.8	10
SSC-M8-SET	M8	1.25	1.25				16	20	25	30	35	40									10	13	8	6	6.3	21.6	6.8	0.4	1.9	13	-	22	10

• When purchasing less volume than one full bag, a separate handling fee is charged. For details, see the Sold Separately Service.

Individual Sales	Cleanroom Wash & Packaging	Screw Length Adjustment	Vibration Resistant	Modification process for captive use
Available / Add'l charge	Available / Add'l charge	Not Available	Not Available	with Captive Processing

Related Products

Use **SKSC** for captive washer mounting.



Part Number Specification

SSC-M6-12-SET

