

SLH-SD/SLHS-SD Socket Head Cap Screws with Low & Small Head

SUS Stainless steel Protrusion Small Head

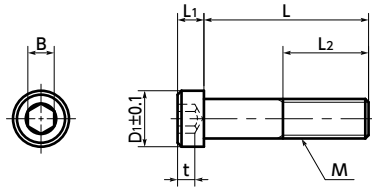

● Application

Reducing the size of equipment and devices

● Material/Finish

	SLH-SD	SLH-SD-EL	SLHS-SD
Main Body	SWCH45K Ferrosferic Oxide Film (Black)	SWCH45K Electroless Nickel Plating	SUSXM7 (Equivalent to SUS304)
Strength Class	8.8	8.8	A2-50

● Usage example

It is possible to perform spot facing and hide the head in locations where spot facing is not possible with standard socket head cap screws.

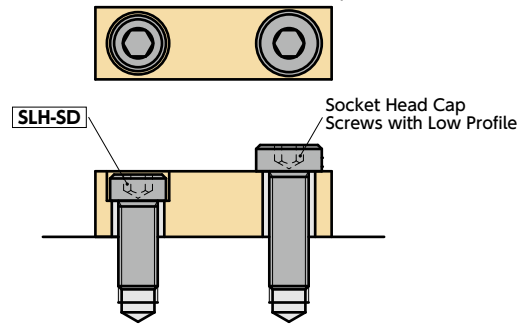

- Socket head cap screws with low profiles and small head diameters. Able to reduce the spot facing diameters compared to standard socket head cap screws with low profiles.

⚠ Precautions for Use

- Since the head bearing surface area is small, bearing surface pressure become high.
- Using the following formula as a reference, ensure that the bearing surface pressure due to screw tightening does not exceed the permitted surface pressure of the intended fastening material.

$$P = \sigma \frac{As}{A}$$

P: Bearing surface pressure (N/mm²)
 σ: Bolt stress (N/mm²)
 As: Screw effective sectional area (mm²)
 A: Bearing surface area (mm²)

$$\text{Bearing surface area } A = \pi \frac{(D_1^2 - d^2)}{4}$$

D₁: Head diameter (mm)
 d: Drilled hole diameter (mm)

● Head Diameter and Screw Effective Cross-sectional Area

Part Number	Head Diameter (mm)	Screw effective cross-sectional area (mm ²)
SLH-M3-SD	4.5	5.03
SLH-M4-SD	5.5	8.78
SLH-M5-SD	7	14.2
SLH-M6-SD	8.5	20.1
SLH-M8-SD	11	36.6
SLH-M10-SD	13.5	58

SLH-SD Steel - Ferrosferic Oxide Coating

Part Number	M (Coarse)		L										D ₁	L ₁	B	t	L ₂ *1	Max. Torque*2 (N·m)	Mass (g)	Qty per pack
	Nominal of Thread	Pitch	6	8	10	12	16	20	25	30	35	40								
SLH-M3-SD	M3	0.5	6	8	10	12							4.5	2	2	1.5	Full Thread	1.4	0.5 - 0.7	10
SLH-M4-SD	M4	0.7	6	8	10	12	16	20	25				5.5	2.8	2.5	2.3	Full Thread	3.4	0.9 - 2.4	10
SLH-M5-SD	M5	0.8	8	10	12	16	20	25				7	3	3	2.2	Full Thread	6	1.7 - 3.8	10	
SLH-M6-SD	M6	1	8	10	12	16	20	25	30			8.5	3.5	4	2.5	18(L=30)	10	2.6 - 6.5	10	
SLH-M8-SD	M8	1.25	10	12	16	20	25	30	35			11	4.5	5	3.3	22(L=35)	27	5.9 - 14	10	
SLH-M10-SD	M10	1.5	16	20	25	30	35	40				13.5	5.5	6	4	Full Thread	46	13 - 25	10	

*1: If the "L" value is not in parentheses, the screw is full thread.

*2: The maximum tightening torque of the screw body. With reference to the Precautions for Use, consider the seating surface pressure when deciding on the tightening torque.

- When purchasing less volume than one full bag, a separate handling fee is charged. For details, see the Sold Separately Service.

SLH-SD-EL Steel - Electroless Nickel Plating

Part Number	M (Coarse)		L										D ₁	L ₁	B	t	L ₂ *1	Max. Torque*2 (N·m)	Mass (g)	Qty per pack
	Nominal of Thread	Pitch	6	8	10	12	16	20	25	30	35	40								
SLH-M3-SD-EL	M3	0.5	6	8	10	12							4.5	2	2	1.5	Full Thread	1.4	0.5 - 0.7	10
SLH-M4-SD-EL	M4	0.7	6	8	10	12	16	20	25				5.5	2.8	2.5	2.3	Full Thread	3.4	0.9 - 2.4	10
SLH-M5-SD-EL	M5	0.8	8	10	12	16	20	25				7	3	3	2.2	Full Thread	6	1.7 - 3.8	10	
SLH-M6-SD-EL	M6	1	8	10	12	16	20	25	30			8.5	3.5	4	2.5	18(L=30)	10	2.6 - 6.5	10	
SLH-M8-SD-EL	M8	1.25	10	12	16	20	25	30	35			11	4.5	5	3.3	22(L=35)	27	5.9 - 14	10	
SLH-M10-SD-EL	M10	1.5	16	20	25	30	35	40				13.5	5.5	6	4	Full Thread	46	13 - 25	10	

*1: If the "L" value is not in parentheses, the screw is full thread.

*2: The maximum tightening torque of the screw body. With reference to the Precautions for Use, consider the seating surface pressure when deciding on the tightening torque.

- When purchasing less volume than one full bag, a separate handling fee is charged. For details, see the Sold Separately Service.

SLHS-SD Stainless Steel

Part Number	M (Coarse)		L										D ₁	L ₁	B	t	L ₂ *1	Max. Torque*2 (N·m)	Mass (g)	Qty per pack
	Nominal of Thread	Pitch	6	8	10	12	16	20	25	30	35	40								
SLHS-M3-SD	M3	0.5	6	8	10	12							4.5	2	2	1.5	Full Thread	0.6	0.5 - 0.7	10
SLHS-M4-SD	M4	0.7	6	8	10	12	16	20	25				5.5	2.8	2.5	2.3	Full Thread	1.5	0.9 - 2.4	10
SLHS-M5-SD	M5	0.8	8	10	12	16	20	25				7	3	3	2.2	Full Thread	3.1	1.7 - 3.8	10	
SLHS-M6-SD	M6	1	8	10	12	16	20	25	30			8.5	3.5	4	2.5	18(L=30)	5.3	2.6 - 6.5	10	
SLHS-M8-SD	M8	1.25	10	12	16	20	25	30	35			11	4.5	5	3.3	22(L=35)	12	5.9 - 14	10	
SLHS-M10-SD	M10	1.5	16	20	25	30	35	40				13.5	5.5	6	4	Full Thread	25	13 - 25	10	

*1: If the "L" value is not in parentheses, the screw is full thread.

*2: The maximum tightening torque of the screw body. With reference to the Precautions for Use, consider the seating surface pressure when deciding on the tightening torque.

- When purchasing less volume than one full bag, a separate handling fee is charged. For details, see the Sold Separately Service.

● Part number specification

