

MOC Flexible Couplings - Oldham Type - Set Screw Type

High torque High Allowable Misalignment Small Eccentric Reaction Force

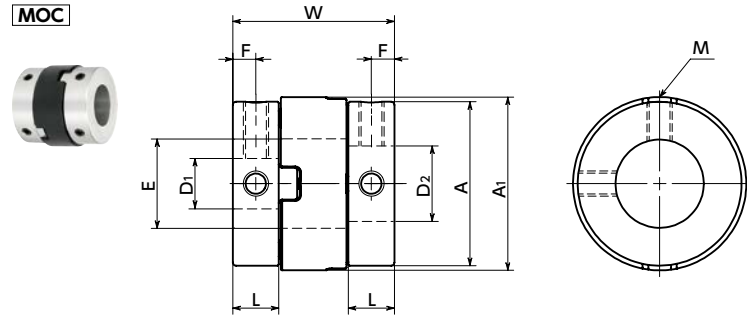

Dimensions

Unit : mm

Part Number	A	A ₁	L	W	E	F	M	Screw Tightening Torque (N·m)
MOC-12	12	12	3.9	14.4	5.2	1.9	M3	0.7
MOC-17	15	16.5	4.4	16	8.2	2.2	M3	0.7
MOC-23	20	22.5	5.8	21.6	12.2	2.9	M4	1.7
MOC-28	26	27.5	7.3	25.6	14.2	3.7	M4	1.7
MOC-33	30	32.5	10	32.6	15.2	5	M4	1.7
MOC-41	38	41	12.1	40.1	18.3	6.1	M5	4

Part Number	Standard Bore Diameter D ₁ · D ₂ (Dimensional Allowance H8)												
	3	4	5	6	8	10	12	14	15	16	18	20	
MOC-12	●	●	●										
MOC-17		●	●	●	●								
MOC-23			●	●	●	●	●						
MOC-28				●	●	●	●	●					
MOC-33					●	●	●	●	●				
MOC-41						●	●	●	●	●	●	●	●

- All products are provided with hex socket head cap screw.
- Recommended tolerance for shaft diameters is h6 and h7.
- A set of hubs with set screw type for one side and clamping type for the other side and others are available upon request.
- For the shaft insertion amount to the coupling, see Mounting/maintenance.

Performance

Part Number	Max. Bore Diameter (mm)	Keyway Additional Modification Max. Bore Diameter	Rated Torque *1 (N·m)	Maximum Torque *1 (N·m)	Max. Rotational Frequency (min ⁻¹)	Moment of Inertia *2 (kg·m ²)	Static Torsional Stiffness (N·m/rad)	Max. Lateral Misalignment (mm)	Max. Angular Misalignment (°)	Mass *2 (g)
MOC-12	5	-	1.2	2.1	3000	6.8 × 10 ⁻⁸	25	1	3	3
MOC-17	8	8	1.8	3.6	3000	2.0 × 10 ⁻⁷	50	1	3	5
MOC-23	12	10	4	8	3000	8.1 × 10 ⁻⁷	150	1.2	3	11
MOC-28	14	14	8	14	3000	2.6 × 10 ⁻⁶	350	1.5	3	24
MOC-33	16	16	16	25	3000	6.1 × 10 ⁻⁶	450	2	3	39
MOC-41	20	20	30	46	3000	1.9 × 10 ⁻⁵	1100	2.5	3	77

*1: If ambient temperature exceeds 30°C, be sure to correct the rated torque and max. torque with temperature correction factor shown in the following table. The allowable operating temperature of MOC is -20°C to 80°C.

*2: These are values with max. bore diameter.

Comparison of Rated Torque

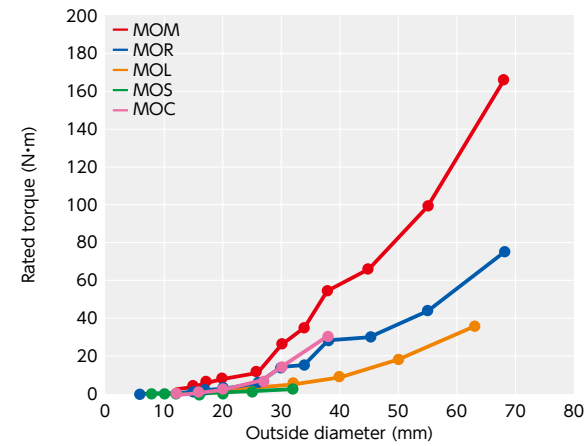

Ambient Temperature / Temperature Correction Factor

Ambient Temperature	Temperature Correction Factor
-20°C to 30°C	1.00
30°C to 40°C	0.80
40°C to 60°C	0.70
60°C to 80°C	0.55

Part number specification

MOC-28-8-12 1 Set

1 2

MOC-23 - SPCR Single Spacer

Product Symbol Outside Diameter (Dimension A) Single Spacer

Additional Keyway at Shaft Hole Available / Add'l charge	Cleanroom Wash & Packaging Please feel free to contact us	Change to Stainless Steel Screw Available / Add'l charge
---	--	---