

# SPA-C Plastic Screw - Hex Socket Head Cap Screws - RENY

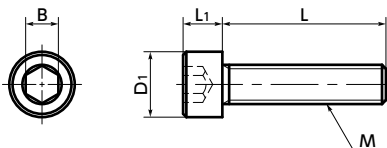

High strength High Specific Strength



● Material/Finish



	<b>SPA-C</b>
Main body	RENY™*1 (50% Glass Fiber Reinforced Polyamide MXD6) (Black)
Heat Resistance Temperature*2	105°C

- \*1: RENY™ is a trademark or registered trademark of Mitsubishi Gas Chemical Company, Inc.
- \*2: This is the value for the plastic material. The maximum operating temperature of the product changes with performance conditions such as tightening torque.

- RENY™ is a thermoplastic super-engineering plastic with excellent tensile and flexural strength.
- Screws have excellent fatigue resistance, creep resistance, and thermal insulation.
- While it is nearly as strong as metal, its weight is approximately 1/5 of iron.
- The properties and precautions of plastic screws

● Application

Electrical and electronic equipment / Insulation and dew condensation prevention for refrigerators and freezers / Aquatic applications / Electrochemical plating / Lightweight applications in automobiles, aircrafts, and spacecrafts

Unit : mm

Part Number	M (Coarse)		L <span style="color:red">❶</span>										D1	L1	B	Tension*1 Rupture Load (N)	Torsional*1 Torque (N·m)	Mass (g)	Qty per pack			
	Nominal of Thread <span style="color:red">❶</span>	Pitch	6	8	10	12	15	20	25	30	35	40								45	50	
<b>SPA-M3-C</b>	M3	0.5	6	8	10	12	15	20								5.5	3	2.5	853	0.36	0.15 - 0.29	20
<b>SPA-M4-C</b>	M4	0.7	6	8	10	12	15	20	25	40						7	4	3	1499	0.85	0.32 - 0.88	20
<b>SPA-M5-C</b>	M5	0.8		8	10	12	15	20	25		30	35				8.5	5	4	2407	1.65	0.52 - 1.3	20
<b>SPA-M6-C</b>	M6	1			10	12	15	20	25	40	30	35	10			10	6	5	3106	2.74	1 - 2.3	10
<b>SPA-M8-C</b>	M8	1.25			10	12	15	20	25	40	30	35	13			13	8	6	5335	6.22	2.2 - 4.4	10
<b>SPA-M10-C</b>	M10	1.5				15	20	25	40	30	35	16				16	10	8	7646	11.39	4.3 - 7	5
<b>SPA-M12-C</b>	M12	1.75					20	25	40	30	35	18				18	12	10	7511	15.93	6.8 - 9.8	5

- \*1: Values in chart are for reference only. They are not guaranteed values. The recommendation torque is 50% of the torsional torque.
- When purchasing less volume than one full bag, a separate handling fee is charged. For details, see the Sold Separately Service.

● Part number specification

## SPA - M5 - 30 - C

Product Code	<span style="color:red">❶</span>	<span style="color:red">❷</span>	Product Code
--------------	----------------------------------	----------------------------------	--------------

Individual Sales → P.0000	Cleanroom Wash & Packaging → P.0000	Screw Length Adjustment → P.0000	Vibration Resistant → P.0000	Modification process for captive use → P.0000
Available / Add'l charge	Available / Add'l charge	Not Available	Not Available	Not Available