

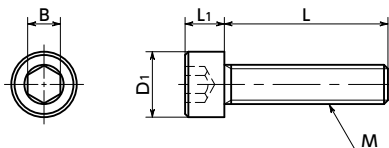

SNSU-AT Socket Head Cap Screws - SUH660

Heat-resistance High strength High Specific Strength SUS Stainless steel



● Material/Finish



	SNSU-AT
Main Body	SUH660 (Equivalent to A286)

● Mechanical Properties

	SUH660
Tensile Strength (N/mm ²)	900 or Higher
0.2% Proof Load (N/mm ²)	590 or Higher
Elongation (%)	15 or Higher

- Mechanical properties are those with solution heat treatment + age hardening material.
- Values in chart are for reference only. They are not guaranteed values.
- Do not exceed the max. tightening torque.
- Always carry out tests under performance conditions similar to actual conditions in advance in order to confirm safety.



- SUH660 hex socket head cap screws.
- SUH660 is heat-resistant austenitic steel equivalent to A286 (ASTM standards), which is mainly used in high-temperature environments.
- The heat resistant temperature is 700°C. Retains high strength even in high temperature environments.
- The strength per each screw is high, so smaller screw diameters and reduced quantities are available to save space and reduce weight.
- For high-specific strength screws which can be made smaller and lighter-weight, see “What is specific strength?”.

● Application

Lighter-weight automobiles, aircrafts/aerospace equipment, robots, etc.
Semiconductor manufacturing equipment / gas turbines/steam turbines / coal-fired generating plants

Unit : mm

Part Number ◀1	M (Coarse)		L ◀2							D1	L1	B	Max. Torque *1 (N·m)	Mass (g)
	Nominal of Thread	Pitch												
SNSU-M3-AT	M3	0.5	6	8	10	12	16	20		5.5	3	2.5	1.3	0.9 - 1.7
SNSU-M4-AT	M4	0.7		8	10	12	16	20	25	7	4	3	2.9	2 - 3.7
SNSU-M5-AT	M5	0.8			10	12	16	20	25	8.5	5	4	5.9	3.8 - 6.1
SNSU-M6-AT	M6	1				12	16	20	25 30	10	6	5	10	6.4 - 10

*1 : Values in chart are for reference only. They are not guaranteed values.

● Part Number Specification

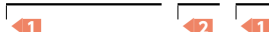
SNSU-M5-16-AT

Individual Sales 1 piece in 1 pack	Cleanroom Wash & Packaging Available / Add'l charge	Screw Length Adjustment Please feel free to contact us	Vibration Resistant Available / Add'l charge	Modification process for captive use Please feel free to contact us
---------------------------------------	--	---	---	--