

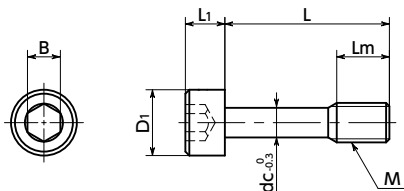

# SSC-SNST Socket Head Cap Captive Screws - Titanium

- Cleanroom wash & packaging
- Chemical-proof
- Non-Magnetic
- Lightweight



● Material/Finish



	<b>SSC-SNST</b>
Main Body	TW340 (Grade 2 Titanium)

● Application

For fixing protective covers and maintenance covers  
 CE Marking compatible  
 Machine tools / Food machinery / Electrical and electronic equipment

● Installation Example

Make a screw hole in the cover, and then pass the **SSC-SNST** thread part through it. Even when the screw is removed from the frame, **SSC-SNST** does not fall out of the cover because the **SSC-SNST** thread part catches on the cover screw hole.

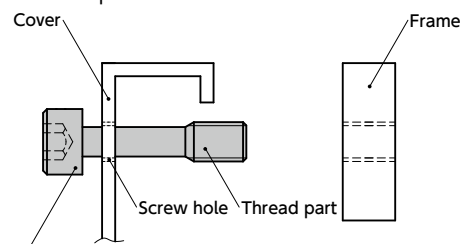

**SSC-SNST** Hex socket head cap captive screw

Precautions for Use

- Screw hole inner diameter on the cover side shall be at least the dc dimension.
- The cover thickness should be 0.8mm or above.

● Part Number Specification

## SSC-SNST-M5-20



Batch cleanroom packing is provided for orders containing multiple items of the same size.

- Prevents fall-off and loss of the screw. They are intended to fix protective and inspection covers that are frequently installed and removed.
- For CE Marking compatibility.
- Non-magnetic.
- Special chemical polishing and brightening treatment improve the quality of the surface. Additionally, products have been cleanroom washed and packed. Cleanroom specification prevents oil and dirt from adhering.
- For the properties of titanium materials, see "Properties of Titanium."

● Mechanical Properties

	TW340 (Grade 2 Titanium)
Tensile Strength (N/mm <sup>2</sup> )	340 - 510
0.2% Proof Load (N/mm <sup>2</sup> )	215 or Higher
Elongation (%)	23 or Higher

● Values in chart are for reference only. They are not guaranteed values.

● Physical Properties

	TW340 (Grade 2 Titanium)
Specific Gravity	4.51
Melting Point (C)	1668
Longitudinal Elastic Modulus (GPa)	106
Thermal Conductivity (W/(m·K))	17.16
Linear Expansion Coefficient (K <sup>-1</sup> )	8.4 × 10 <sup>-6</sup>
Electric Resistance (μΩ·m)	0.55
Magnetic Permeability (μ)	1.0001 (Nonmagnetic)

● Values in chart are for reference only. They are not guaranteed values.

Unit : mm

Part Number	M (Coarse)		L							Lm	D1	L1	B	dc	Mass (g)
	Nominal of Thread	Pitch													
<b>SSC-SNST-M3</b>	M3	0.5	8	10	12	16				4	5.5	3	2.5	2.2	0.42 - 0.58
<b>SSC-SNST-M4</b>	M4	0.7		10	12	16	20			5	7	4	3	3	0.93 - 1.3
<b>SSC-SNST-M5</b>	M5	0.8			12	16	20	25		6	8.5	5	4	3.9	1.6 - 2.3
<b>SSC-SNST-M6</b>	M6	1			12	16	20	25	30	8	10	6	5	4.5	2.6 - 3

Individual Sales	Cleanroom Wash & Packaging	Screw Length Adjustment	Vibration Resistant	Modification process for captive use with Captive Processing
1 piece in 1 pack	Cleanroom washed and packed	Not Available	Not Available	