

# SVSH-C22 Hex Socket Head Cap Screws (Hastelloy C - 22 equiv.) with Ventilation Hole

Vacuum Cleanroom wash & packaging Chemical-proof

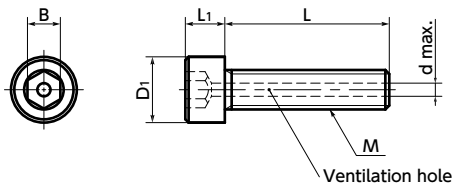

● Material/Finish



	<b>SVSH-C22</b>
Main Body	UNS N06022 (Hastelloy*1C-22 equiv.)

\*1: Hastelloy is a registered trademark of Haynes International, Inc.

● Mechanical property

	Hastelloy (UNS N06022)	SUS304
Tensile Strength (N/mm <sup>2</sup> )	690 or More	520 or More
0.2% Proof Load (N/mm <sup>2</sup> )	310 or More	205 or More
Elongation (%)	45 or More	40 or More

● Values in chart are for reference only. They are not guaranteed values.

● Physical property

	Hastelloy (UNS N06022)	SUS304
Specific Gravity	8.69	7.93
Longitudinal Elastic Modulus (GPa)	206	193
Specific Heat (J/kg·K)	414	500
Electric Resistance (μΩ·m)	1.14	0.7
Linear Expansion Coefficient (K <sup>-1</sup> )	12.4×10 <sup>-6</sup>	17.3×10 <sup>-6</sup>

● Values in chart are for reference only. They are not guaranteed values.

- Hastelloy C-22 hex socket head cap screws **SVSH-C22** with ventilation hole.
- The ventilation hole easily releases gas trapped in the screw holes of equipment and machines, and supports vacuum drawing of vacuum devices.
- Hastelloy C-22 is one of the few metals which can withstand wet chlorine gas, hypochlorite, and chlorine dioxide.
- Excellent corrosion resistance against oxidizing and reducing acids and salts. ➔ P.xxxx
- Supports use with vacuum equipment in corrosive environments.
- Cleanroom wash/cleanroom packing provided. ➔ P.xxxx
- Application

Vacuum devices / Vacuum chambers / FPD production equipment / Semiconductor manufacturing equipment / Electron microscopes / Printed circuit board etching devices / Metallic surface treatment equipment and facilities / Chemical plants

Unit : mm

Part Number <span style="color:red">①</span>	M (Coarse)		L <span style="color:red">②</span>	D1	L1	B	d max.	Mass (g)
	Nominal of Thread	Pitch						
<b>SVSH-M3-C22</b>	M3	0.5	6 8 10 12 16 20	5.5	3	2.5	1.2	0.79 - 1.5
<b>SVSH-M4-C22</b>	M4	0.7	8 10 12 16 20 25	7	4	3	1.5	1.8 - 3.5
<b>SVSH-M5-C22</b>	M5	0.8	10 12 16 20 25	8.5	5	4	1.5	3 - 5.3
<b>SVSH-M6-C22</b>	M6	1	12 16 20 25 30	10	6	5	2	5.6 - 9.2
<b>SVSH-M8-C22</b>	M8	1.25	16 20 25 30 35	13	8	6	2	13 - 21

● Part number specification

## SVSH-M5-16-C22

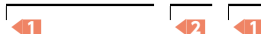

Batch cleanroom packing is provided for orders containing multiple items of the same size.

Individual Sales ➔ P.xxxx	Cleanroom Wash & Packaging ➔ P.xxxx	Screw Length Adjustment ➔ P.xxxx	Vibration Resistant ➔ P.xxxx	Modification process for captive use ➔ P.xxxx
1 piece in 1 pack	Cleanroom washed and packed	Available / Add'l charge	Not Available	Please feel free to contact us