

KUMS-BK Knurled Knob (Stainless Steel Black)

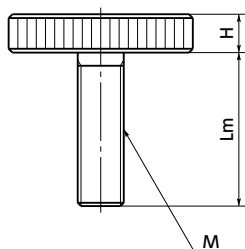

SUS Stainless steel

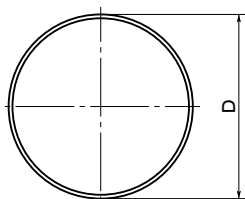

- Stainless steel black is surface treatment with passive film on the stainless steel surface grown 200 times more than normally to produce deep black. After the treatment, corrosion resistance and weather resistance is significantly improved.
- No impurities are contained in the film itself and only a trace amount of outgas exists in a vacuum environment.
- Spectral reflectivity of 1.5% or below. For applications such as optical equipment that requires antireflection. → P.xxxx
- Deep black. For decorated surfaces of equipment / device.
- Material/Finish



| | KUMS-BK |
|-----------|---------------------------------|
| Main body | SUS303 Stainless steel black |

Dimensions

Unit : mm

| Part Number | D ¹ | M (Coarse) | | H | Mass (g) |
|---------------|----------------|--------------------------------|-------|-----|----------|
| | | Nominal of Thread ² | Pitch | | |
| KUMS-16-M4-BK | 16 | M4 | 0.7 | 3.5 | 5 - 7 |
| KUMS-20-M5-BK | 20 | M5 | 0.8 | 4 | 12 - 13 |
| KUMS-24-M6-BK | 24 | M6 | 1 | 5 | 20 - 25 |

| Part Number | Lm (mm) ³ | | | | | |
|---------------|----------------------|----|----|----|----|----|
| | 6 | 10 | 16 | 20 | 25 | 30 |
| KUMS-16-M4-BK | ● | ● | ● | | | |
| KUMS-20-M5-BK | | ● | ● | ● | | |
| KUMS-24-M6-BK | | ● | ● | ● | ● | ● |

- Part number specification

KUMS-24-M6-20-BK

Product code ¹ ² ³ Stainless Steel Black

For ³ screw length Lm, select from the sizes marked with ● in the table.

| | | | | |
|-------------------------------------|----------------------------|----------------------------------|------------------------------|--------------------------|
| Cleanroom Wash & Packaging → P.xxxx | Screw Combination → P.xxxx | Screw Length Adjustment → P.xxxx | Vibration Resistant → P.xxxx | Laser Marking → P.xxxx |
| Please feel free to contact us | Not Available | Not Available | Not Available | Available / Add'l charge |