

SSH Hex Socket Head Cap Screws with Special Low Profile

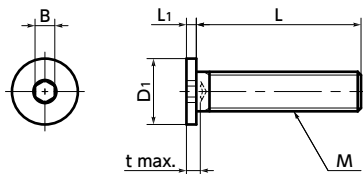

● Material/Finish



| | SSH | SSH-EL |
|----------------|---|---|
| Main Body | SCM435 Ferrosoferric Oxide Coating (Black) | SCM435 Electroless Nickel Plating |
| Strength Class | Thread : 10.9 Head*1 : 5.8 (M2 - M8) 4.8 (M10) | Thread : 10.9 Head*1 : 5.8 (M2 - M8) 4.8 (M10) |

*1 : Do not exceed the max. tightening torque. Though strength is increased through heat treatment, the head strength is less than that of thread.

SSH

SSH-EL

- The head height for all screws is 1.5 mm or less.
- Intended for reducing the size of devices and applications with limited overhead space.
- Also, **SVSHS** Socket Head Cap Screws with Special Low Profile with Ventilation Hole (→ P.xxxx), and **SSHs-FT** Socket Head Cap Screws with Special Low Profile with long thread (→ P.xxxx) are available.

● Application

Reducing the size of equipment and devices

SSH Made of Steel · Ferrosoferric Oxide Film

Unit : mm

| Part Number | M (Coarse) | | L | | | | | | | | | | D1 | L1 | B | t | Max. Torque (N·m) | Mass (g) | Qty per pack | | |
|-------------|-------------------|-------|---|---|---|---|----|----|----|----|----|----|----|-----|----|-----|-------------------|----------|--------------|-------------|----|
| | Nominal of Thread | Pitch | | | | | | | | | | | | | | | | | | | |
| SSH-M2 | M2 | 0.4 | 4 | 5 | 6 | 8 | 10 | 12 | | | | | | | 4 | 1.1 | 1.3 | 1.2 | 0.3 | 0.11 - 0.29 | 10 |
| SSH-M2.5 | M2.5 | 0.45 | 4 | 5 | 6 | 8 | 10 | 12 | | | | | | | 5 | 1.3 | 1.3 | 1.5 | 0.4 | 0.23 - 0.47 | 10 |
| SSH-M3 | M3 | 0.5 | 4 | 5 | 6 | 8 | 10 | 12 | | | | | | | 6 | 1.3 | 1.5 | 2 | 0.7 | 0.36 - 0.69 | 10 |
| SSH-M4 | M4 | 0.7 | | | 6 | 8 | 10 | 12 | 16 | 20 | | | | | 8 | 1.5 | 2 | 2.5 | 1.7 | 0.89 - 1.9 | 10 |
| SSH-M5 | M5 | 0.8 | | | 6 | 8 | 10 | 12 | 16 | 20 | 25 | | | | 9 | 1.5 | 3 | 3 | 6.2 | 0.73 - 3.1 | 10 |
| SSH-M6 | M6 | 1 | | | 6 | 8 | 10 | 12 | 16 | 20 | 25 | 30 | | | 10 | 1.5 | 3 | 4 | 6.3 | 1.2 - 5.5 | 10 |
| SSH-M8 | M8 | 1.25 | | | | 8 | 10 | 12 | 16 | 20 | 25 | 30 | | | 13 | 1.5 | 4 | 5 | 14 | 3 - 10 | 10 |
| SSH-M10 | M10 | 1.5 | | | | | 10 | 12 | 16 | 20 | 25 | 30 | 16 | 1.5 | 5 | 6 | 27 | 4.6 - 15 | 10 | | |

*1 : Values in chart are for reference only. They are not guaranteed values.

● When purchasing less volume than one full bag, a separate handling fee is charged. For details, see the Sold Separately Service.

SSH-EL Made of Steel · Electroless Nickel Plating

Unit : mm

| Part Number | M (Coarse) | | L | | | | | | | | | | D1 | L1 | B | t | Max. Torque (N·m) | Mass (g) | Qty per pack | | |
|-------------|-------------------|-------|---|---|---|---|----|----|----|----|----|----|----|-----|----|-----|-------------------|----------|--------------|-------------|----|
| | Nominal of Thread | Pitch | | | | | | | | | | | | | | | | | | | |
| SSH-M2-EL | M2 | 0.4 | 4 | 5 | 6 | 8 | 10 | 12 | | | | | | | 4 | 1.1 | 1.3 | 1.2 | 0.3 | 0.11 - 0.29 | 10 |
| SSH-M2.5-EL | M2.5 | 0.45 | 4 | 5 | 6 | 8 | 10 | 12 | | | | | | | 5 | 1.3 | 1.3 | 1.5 | 0.4 | 0.23 - 0.47 | 10 |
| SSH-M3-EL | M3 | 0.5 | 4 | 5 | 6 | 8 | 10 | 12 | | | | | | | 6 | 1.3 | 1.5 | 2 | 0.7 | 0.36 - 0.69 | 10 |
| SSH-M4-EL | M4 | 0.7 | | | 6 | 8 | 10 | 12 | 16 | 20 | | | | | 8 | 1.5 | 2 | 2.5 | 1.7 | 0.89 - 1.9 | 10 |
| SSH-M5-EL | M5 | 0.8 | | | 6 | 8 | 10 | 12 | 16 | 20 | 25 | | | | 9 | 1.5 | 3 | 3 | 6.2 | 0.73 - 3.1 | 10 |
| SSH-M6-EL | M6 | 1 | | | 6 | 8 | 10 | 12 | 16 | 20 | 25 | 30 | | | 10 | 1.5 | 3 | 4 | 6.3 | 1.2 - 5.5 | 10 |
| SSH-M8-EL | M8 | 1.25 | | | | 8 | 10 | 12 | 16 | 20 | 25 | 30 | | | 13 | 1.5 | 4 | 5 | 14 | 3 - 10 | 10 |
| SSH-M10-EL | M10 | 1.5 | | | | | 10 | 12 | 16 | 20 | 25 | 30 | 16 | 1.5 | 5 | 6 | 27 | 4.6 - 15 | 10 | | |

*1 : Values in chart are for reference only. They are not guaranteed values.

● When purchasing less volume than one full bag, a separate handling fee is charged. For details, see the Sold Separately Service.

● Part number specification

SSH-M5-20-EL



| | | | | |
|---------------------------|-------------------------------------|----------------------------------|------------------------------|---|
| Individual Sales → P.xxxx | Cleanroom Wash & Packaging → P.xxxx | Screw Length Adjustment → P.xxxx | Vibration Resistant → P.xxxx | Modification process for captive use → P.xxxx |
| Available / Add'l charge | Please feel free to contact us | Available / Add'l charge | Available / Add'l charge | Not Available |