

Shape 1

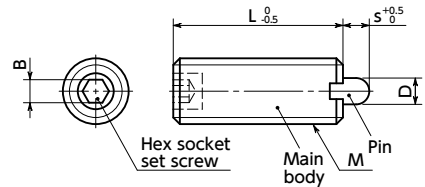

Shape 2

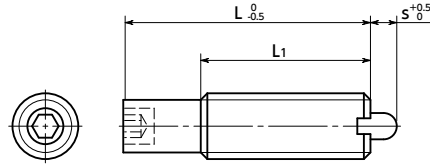

PSPS-S PSPS-NS Heavy Load PSPS-Z PSPS-NZ Super Heavy Load

Part Number <small>Stainless Steel Pin</small>	Part Number <small>Plastic Pin</small>	M (Coarse)		s	L	L <sub>1</sub>	D	B	Applicable Ball Button <b>BB</b>	Applicable Wrench *1 <b>PPW</b>	Load (N) min./max.	Shape	Mass (g)
		Nominal of Thread	Pitch										
PSPS-3-1.5-S	PSPS-3-1.5-NS	M3	0.5	1.5	15	-	1.1	0.9	BB-4	-	0.8 / 2.94	1	0.5
PSPS-3-3-S	PSPS-3-3-NS	M3	0.5	3	15	-	1.1	0.9	BB-4	-	0.6 / 2.93	1	0.5
PSPS-4-2-S	PSPS-4-2-NS	M4	0.7	2	15	-	1.6	1.3	BB-4	-	2 / 8.8	1	0.7
PSPS-4-4-S	PSPS-4-4-NS	M4	0.7	4	24	-	1.6	1.3	BB-4	-	1.9 / 8.75	1	2.4
PSPS-5-3-S	PSPS-5-3-NS	M5	0.8	3	20	-	2	1.5	BB-5	PPW-5	2.7 / 16.3	1	2
PSPS-5-5-S	PSPS-5-5-NS	M5	0.8	5	27	-	2	1.5	BB-5	PPW-5	1 / 17.1	1	2.6
PSPS-6-3-S	PSPS-6-3-NS	M6	1	3	25	-	2.5	2	BB-6	PPW-6	8 / 26.4	1	3
PSPS-6-5-S	PSPS-6-5-NS	M6	1	5	30	-	2.5	2	BB-6	PPW-6	4.4 / 26.4	1	4
PSPS-8-3-S	PSPS-8-3-NS	M8	1.25	3	25	-	3.1	2.5	BB-8	PPW-8	14.7 / 27	1	6
PSPS-8-5-S	PSPS-8-5-NS	M8	1.25	5	27	-	3.1	2.5	BB-8	PPW-8	6.7 / 26.6	1	6.6
PSPS-10-5-S	PSPS-10-5-NS	M10	1.5	5	30	-	3.8	3	BB-8	PPW-10	8.2 / 45.7	1	11
PSPS-10-10-S	PSPS-10-10-NS	M10	1.5	10	43	30	3.8	3	BB-8	PPW-10	6.2 / 26.6	2	16.1
PSPS-12-5-S	PSPS-12-5-NS	M12	1.75	5	30	-	5.5	4	BB-10	PPW-12	18.2 / 49	1	15
PSPS-12-10-S	PSPS-12-10-NS	M12	1.75	10	43	35	5.5	4	BB-10	PPW-12	8.2 / 49.1	2	22.2
PSPS-12-15-S	PSPS-12-15-NS	M12	1.75	15	51	35	5.5	4	BB-10	PPW-12	7.5 / 48.9	2	26.2
PSPS-16-10-S	PSPS-16-10-NS	M16	2	10	57	35	8	5	BB-12	PPW-16	18.9 / 68.5	2	48.4
PSPS-16-15-S	PSPS-16-15-NS	M16	2	15	57	35	8	5	BB-12	PPW-16	14.4 / 68.6	2	49
PSPS-16-20-S	PSPS-16-20-NS	M16	2	20	65	35	8	5	BB-12	PPW-16	4.2 / 68.6	2	58.8
PSPS-3-1.5-Z	PSPS-3-1.5-NZ	M3	0.5	1.5	15	-	1.1	0.9	BB-4	-	1.1 / 3.42	1	0.5
PSPS-3-3-Z	PSPS-3-3-NZ	M3	0.5	3	15	-	1.1	0.9	BB-4	-	0.8 / 3.41	1	0.5
PSPS-4-2-Z	PSPS-4-2-NZ	M4	0.7	2	15	-	1.6	1.3	BB-4	-	6.1 / 13.8	1	0.7
PSPS-4-4-Z	PSPS-4-4-NZ	M4	0.7	4	24	-	1.6	1.3	BB-4	-	5.8 / 13.6	1	2.4
PSPS-5-3-Z	PSPS-5-3-NZ	M5	0.8	3	20	-	2	1.5	BB-5	PPW-5	6.8 / 22	1	2
PSPS-5-5-Z	PSPS-5-5-NZ	M5	0.8	5	27	-	2	1.5	BB-5	PPW-5	5.7 / 21.5	1	2.6
PSPS-6-3-Z	PSPS-6-3-NZ	M6	1	3	25	-	2.5	2	BB-6	PPW-6	15.8 / 35.6	1	3
PSPS-6-5-Z	PSPS-6-5-NZ	M6	1	5	30	-	2.5	2	BB-6	PPW-6	12.9 / 34.4	1	4
PSPS-8-3-Z	PSPS-8-3-NZ	M8	1.25	3	25	-	3.1	2.5	BB-8	PPW-8	21.9 / 36.3	1	6
PSPS-8-5-Z	PSPS-8-5-NZ	M8	1.25	5	27	-	3.1	2.5	BB-8	PPW-8	14.7 / 34.5	1	6.6
PSPS-10-5-Z	PSPS-10-5-NZ	M10	1.5	5	30	-	3.8	3	BB-8	PPW-10	24.5 / 58.6	1	11
PSPS-10-10-Z	PSPS-10-10-NZ	M10	1.5	10	43	30	3.8	3	BB-8	PPW-10	19.8 / 58.7	2	16.1
PSPS-12-5-Z	PSPS-12-5-NZ	M12	1.75	5	30	-	5.5	4	BB-10	PPW-12	34.9 / 63.6	1	15
PSPS-12-10-Z	PSPS-12-10-NZ	M12	1.75	10	43	35	5.5	4	BB-10	PPW-12	25.5 / 63.6	2	22.4
PSPS-12-15-Z	PSPS-12-15-NZ	M12	1.75	15	51	35	5.5	4	BB-10	PPW-12	20.1 / 63.7	2	26.1
PSPS-16-10-Z	PSPS-16-10-NZ	M16	2	10	57	35	8	5	BB-12	PPW-16	38.7 / 88.4	2	48.4
PSPS-16-15-Z	PSPS-16-15-NZ	M16	2	15	57	35	8	5	BB-12	PPW-16	33.9 / 88.1	2	48.7
PSPS-16-20-Z	PSPS-16-20-NZ	M16	2	20	65	35	8	5	BB-12	PPW-16	25.4 / 88.1	2	58.9

\*1: Use a slotted screwdriver with **PSPS-3-1.5**, **PSPS-3-3**, **PSPS-4-2**, and **PSPS-4-4**.

Cleanroom Wash & Packaging Please feel free to contact us	Vibration Resistant Available / Add'l charge	Laser Marking Not Available
--	---	--------------------------------

- Short stroke plunger made of stainless steel. It has excellent corrosion resistance.
- **PSPS-NS** and **PSPS-NZ** have a plastic pin. Workpiece damage can be avoided.
- We also produce products of special specifications, e.g. dimensions, load and materials.
- Pin materials and load types can be selected by the end symbol of the part number.

End Symbol	Pin Material	Load Type
<b>S</b>	Stainless Steel	Heavy Load
<b>Z</b>	Stainless Steel	Super Heavy Load
<b>NS</b>	Plastic	Heavy Load
<b>NZ</b>	Plastic	Super Heavy Load

• Material/Finish

	PSPS-S / PSPS-Z	PSPS-NS / PSPS-NZ
Main Body	Equivalent to SUS304	Equivalent to SUS304
Hex Socket Set Screw	SCM435	SCM435
Pin	SUS440C (Hardness: 55 - 60 HRC)	Polyacetal (White)
Spring	SUS631J1	SUS631J1

• Hexagon socket part is colored for identification. **PSPS-S**  
**PSPS-NS** Red / **PSPS-Z** / **PSPS-NZ** Blue

- Precautions for Use**  
When fixing the plunger for use with adhesive, etc., we recommend mounting and removing from the pin side with plunger wrench **PPW**.  
If a hex socket is used, the hex socket set screw attached to the main body may detach.

- **Related Products**  
Use a ball button **BB** with excellent abrasion resistance on the recipient.



- A dedicated plunger wrench **PPW** for mounting or removal from the pin side is available.



- Usage example  
For product extrusion.

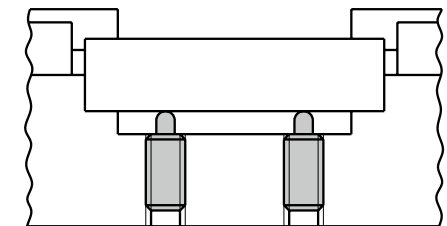

- Part Number Specification

**PSPS-6-3-NS**

