

SUS Stainless steel

### TGY Male Screw

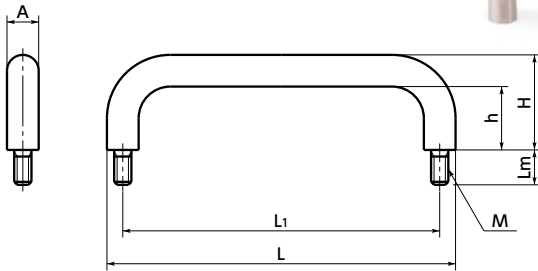

### TG Female Screw

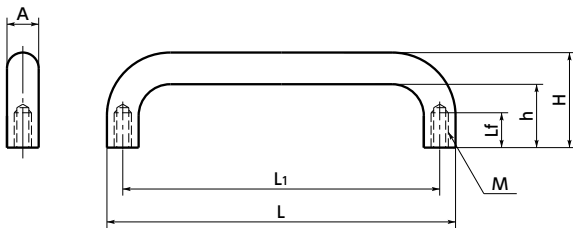

- Pull made of stainless steel.
- Use it in combination with the washer **LY-N** (→ P.xxxx).  
\*Washers are not supplied.
- Male screw/female screw can be selected according to the product code.
  - TGY** — Male screw
  - TG** — Female screw
- For **TG**, hex socket head cap screws for mounting (SUSXM7) are available as an option. Use the screw supply service (charged separately).

### TGY Male Screw

Unit : mm

Part Number	L	A	L1	H	h	Lm	M	Allowable load*1 (N)	Mass (g)	Applicable Washer
<b>TGY-86</b>	86	6	80	30	24	10	M4	1000	30	LY-10
<b>TGY-108</b>	108	8	100	35	27	10	M5	1000	62	LY-12
<b>TGY-110</b>	110	10	100	30	20	11	M5	1000	89	LY-16A
<b>TGY-128</b>	128	8	120	40	32	10	M5	1000	74	LY-12
<b>TGY-130</b>	130	10	120	40	30	11	M6	1000	114	LY-16

\*1 : Allowed load for a person.

### TG Female Screw

Unit : mm

Part Number	L	A	L1	H	h	Lf	M	Allowable load*1 (N)	Mass (g)	Applicable Washer	Screw supply service Screw size
<b>TG-24</b>	24	4	20	22	18	7	M2.6	1000	4.5		M2.6×8
<b>TG-46</b>	46	6	40	22	16	7	M4	1000	14	LY-10-N	M4×8
<b>TG-66</b>	66	6	60	22	16	7	M4	1000	18.5	LY-10-N	M4×8
<b>TG-86</b>	86	6	80	30	24	10	M4	1000	26	LY-10-N	M4×12
<b>TG-108</b>	108	8	100	35	27	10	M5	1000	55.5	LY-12-N	M5×12
<b>TG-110</b>	110	10	100	30	20	11	M5	1000	82	LY-16-N	M5×12
<b>TG-128</b>	128	8	120	40	32	10	M5	1000	68	LY-12-N	M5×12
<b>TG-130</b>	130	10	120	40	30	11	M6	1000	104	LY-16-N	M6×12

\*1 : Allowed load for a person.

### ● Material/Finish



	TGY / TG
Main body	SUS303 Buffing
Hex Socket Head Cap Screws (Screw supply service)	SUSXM7

### ● Part number specification

**TG-24**



**TG-24-P**



Screw supply service

When using the screw supply service (charged separately), add **-P** to the end of the product code.

Cleanroom Wash & Packaging → P.xxxx

Please feel free to contact us

Laser Marking → P.xxxx

Available / Add'l charge