

NSCSS-SP2 Set Collars with Mounting Hole - Stainless Steel - Split Type

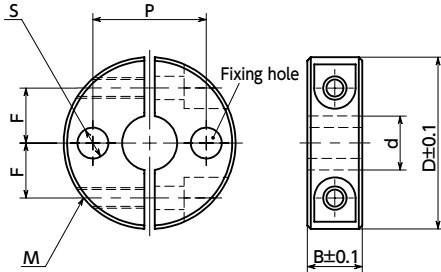

SUS Stainless steel



Material/Finish



	NSCSS-SP2
Main Body	SUS304
Hex Socket Head Cap Screw	SUSXM7

- Set collars with mounting hole. Can be mounted to any machine or device, such as wheels, flanges and plates, by using the mounting hole.
- Split type. Because the shaft hole part can be fully split, mounting and removal are easy, with no damage to the shaft.
- Optimal for use with machines and devices that are difficult to disassemble.

Unit : mm

Part Number	d	B	D	F	S*1	P	M (Coarse)*2	Mass (g)
NSCSS-8-8-SP2	8	8	25	8	4.5	16.5	M3	22
NSCSS-8-10-SP2	8	10	25	8	4.5	18	M4	28
NSCSS-8-12-SP2	8	12	28	8.5	5.5	18	M5	43
NSCSS-8-15-SP2	8	15	30	9	4.5	19	M6	62
NSCSS-10-10-SP2	10	10	30	9	5.5	20	M4	39
NSCSS-10-12-SP2	10	12	30	9	5.5	20	M5	47
NSCSS-10-15-SP2	10	15	35	10	5.5	22.5	M6	83
NSCSS-12-10-SP2	12	10	30	10	5.5	21	M4	37
NSCSS-12-12-SP2	12	12	30	10	5.5	21	M5	46
NSCSS-12-15-SP2	12	15	35	11	5.5	23.5	M6	81
NSCSS-15-10-SP2	15	10	32	11	5.5	24.5	M4	40
NSCSS-15-12-SP2	15	12	35	12	5.5	25	M5	62
NSCSS-15-15-SP2	15	15	40	13	5.5	27.5	M6	107
NSCSS-16-10-SP2	16	10	35	12	5.5	25.5	M4	49
NSCSS-16-12-SP2	16	12	35	12	5.5	25.5	M5	60
NSCSS-16-15-SP2	16	15	40	13	5.5	28	M6	105
NSCSS-20-10-SP2	20	10	40	14	5.5	30	M4	63
NSCSS-20-12-SP2	20	12	40	14	5.5	30	M5	76
NSCSS-20-15-SP2	20	15	45	15	5.5	32.5	M6	127
NSCSS-25-12-SP2	25	12	45	17	6.6	35	M5	88
NSCSS-25-15-SP2	25	15	50	18	6.6	37.5	M6	151
NSCSS-30-15-SP2	30	15	55	20	6.6	42.5	M6	169
NSCSS-35-15-SP2	35	15	60	23	6.6	47.5	M6	194
NSCSS-40-18-SP2	40	18	70	26	9	55	M8	319
NSCSS-50-22-SP2	50	22	85	32	11	67.5	M10	552

*1 : Mounting screws are not supplied. The customer is asked to prepare them.

*2 : Hex socket head cap screw for tightening is provided.

Part Number Specification

NSCSS-8-8-SP2



Cleanroom Wash & Packaging	Screw Length Adjustment	Vibration Resistant	Laser Marking
Please feel free to contact us	Not Available	Not Available	Available / Add'l charge