

SSHL-UCL Hex Socket Head Cap Screws with Special Low Profile (SUS316L / Cleanroom Washing/Cleanroom Packing)

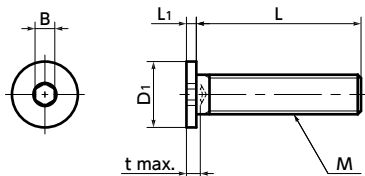

- Protrusion
- Cleanroom wash & packaging
- Chemical-proof
- Non-Magnetic
- SUS Stainless steel



● Material/Finish



| | |
|----------------|-------------------------|
| | SSHL-UCL |
| Main Body | SUS316L USC Cleaning |
| Strength Class | A4 - 70 |

● Application

Reducing the size of equipment and devices
 FPD manufacturing equipment / Semiconductor manufacturing equipment /
 Medical equipment / Food related machinery

● Part Number Specification

SSHL-M5-12-UCL



- SUS316L hex socket head cap screw with special low profile.
- All head heights are 1.5 mm or less. For space-saving of equipment/devices and applications with limited overhead space.
- Compared to SUS304, SUS316L has excellent hydrogen embrittlement resistance, fluorine and chlorine gas resistance, and heat resistance. This screw also has corrosion resistance against chemical products and seawater environments that matches or exceeds SUS304.
- SUS316L is non-magnetic.
- SUS316L is a stainless steel made by adding Mo to SUS304, so it has high pitting resistance and oxidation resistance. Due to its reduced carbon, it also has high intergranular corrosion resistance.
- Because the basic components include Mo, the strength is high even at high temperatures.
- Cleanroom wash/cleanroom packing provided.
- For parts embedded in FPD production devices, semiconductor manufacturing devices, medical equipment, or food machinery, or used in cleanrooms.
- SUS304 equivalent **SSHS-UCL** is available.

SSHL-UCL

SSHS-UCL



To distinguish it from **SSHS-UCL**, **SSHL-UCL** has a cup point tip.

Unit : mm

| Part Number | M (Coarse) | | L | | | D1 | L1 | B | t max. | Mass (g) | Qty per Pack |
|--------------------|-------------------|-------|---|----|----|----|-----|-----|--------|-------------|--------------|
| | Nominal of Thread | Pitch | | | | | | | | | |
| SSHL-M3-UCL | M3 | 0.5 | 6 | 8 | 10 | 6 | 1.3 | 1.5 | 2 | 0.44 - 0.61 | 10 |
| SSHL-M4-UCL | M4 | 0.7 | 6 | 8 | 10 | 8 | 1.5 | 2 | 2.5 | 0.89 - 1.2 | 10 |
| SSHL-M5-UCL | M5 | 0.8 | 8 | 10 | 12 | 9 | 1.5 | 3 | 3 | 0.98 - 1.5 | 10 |

● When purchasing less volume than one full bag, a separate handling fee is charged. For details, see the Sold Separately Service.

| | | | | |
|--------------------------|-----------------------------|--------------------------|---------------------|--------------------------------------|
| Individual Sales | Cleanroom Wash & Packaging | Screw Length Adjustment | Vibration Resistant | Modification process for captive use |
| Available / Add'l charge | Cleanroom washed and packed | Available / Add'l charge | Not Available | Not Available |