

SVSQLG Washer Integrated Hex Socket Head Cap Screws with Ventilation Hole - High Strength Stainless Steel

SUS Stainless steel Vacuum Cleanroom wash & packaging Heat-resistance Chemical-proof Non-Magnetic High strength High Specific Strength

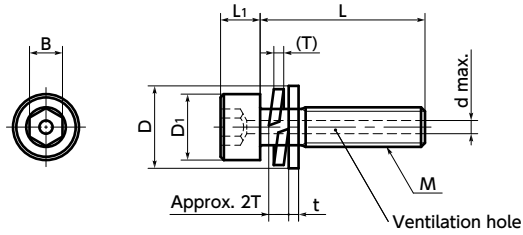

● Material/Finish

	SVSQLG	RoHS
Main Body	SUS316L	
Plain Washer	SUS316L (Hardness: 300 - 400 HV)	
Spring Washer	SUS316L	

● Mechanical property

	SUS316L
Tensile Strength (N/mm ²)	1000
0.2% Proof Load (N/mm ²)	800
Elongation (mm)	0.3d

● Values in chart are for reference only. They are not guaranteed values.

- Washer integrated hex socket head cap screws high strength stainless steel **SVSQLG** ventilation hole type.
- Easier discharge of gas accumulated at the bottom of screw holes from the ventilation hole and gas accumulated in drill holes from the spring washer clearance, supporting vacuum drawing of vacuum devices.

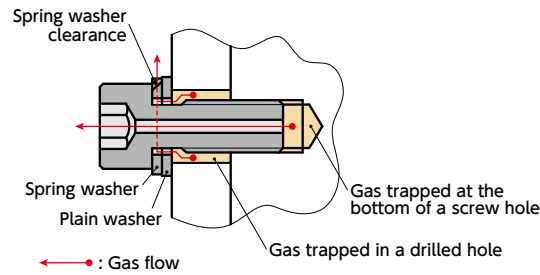

- Bolt tensile strength is 1000 N/mm², 0.2% proof load 800 N/mm². A plain washer of hardness 300 HV or higher, suited to the bolt strength, is built in.
- The proof load is approximately 1.8 times that of general stainless steel hex socket head cap screws. Therefore, smaller screw diameters and reduced quantities are available to save space and reduce weight.
- Plain washers and spring washers are integrated into the screws, preventing concerns about fallout issues.
- Washer mounting work is not required. Cleanroom work in gloves is easier.
- Made of SUS316L. It has excellent corrosion resistance.
- Non-magnetic.
- Cleanroom wash/cleanroom packing provided. → P. xxxx

● Application

Vacuum devices / Vacuum chambers / FPD production equipment / Semiconductor manufacturing equipment / Electron microscopes



Unit : mm

Part Number	M (Coarse)		L	D1	D	t	T (Approx.)	L1	B	d Max.	Mass (g)	Qty per Pack
	Nominal of Thread	Pitch										
SVSQLG-M3	M3	0.5	8 10 12 15 20 25	5.5	6	0.5	0.7	3	2.5	1.2	0.83 - 1.6	10
SVSQLG-M4	M4	0.7	10 12 15 20 25	7	8	0.8	1.0	4	3	1.5	1.6 - 2.7	10
SVSQLG-M5	M5	0.8	10 12 15 20 25 30	8.5	10	1.0	1.3	5	4	1.5	3.4 - 6.3	10
SVSQLG-M6	M6	1	12 15 20 25 30	10	11.5	1.6	1.5	6	5	2	6.3 - 8.9	10

● When purchasing less volume than one full bag, a separate handling fee is charged. For details, see the Sold Separately Service.

Individual Sales → P. xxxx	Cleanroom Wash & Packaging → P. xxxx	Screw Length Adjustment → P. xxxx	Vibration Resistant → P. xxxx	Modification process for captive use → P. xxxx
Available / Add'l charge	Cleanroom washed and packed	Please feel free to contact us	Not Available	Not Available

● Part number specification

SVSQLG-M4-12

